

Date:

December 2015

Description:

ARB Dual Battery Tray

Application:

Toyota Hilux 2015 on

Part No. & Barcode :

4214070 - 9332018040787

Product Group:

384 ARB Aux Battery Trays

Fitting:

1 Hour (plus wiring)

Availability Date:

In Stock



Product Specification

The latest product developed for the 2016 Toyota Hilux is an ARB dual battery tray. The tray has been designed around fitment of Redarc's BCDC range of chargers in conjunction with the ARB Dual Battery Wiring Kit part number 4300010.

With the extensive range of Redarc BCDC chargers allowing a ARB dual battery system to be specified to your customers' requirements a separate ARB Dual Battery Kit is not being developed.

The tray mounts in the passenger side rear corner of the engine bay (Right hand drive vehicles). Due to limited space the battery needs to be fitted in the correct orientation with the negative terminal at the rear of the tray against the firewall on the inboard side.

Features:

- Vehicle specific design for the 2016 Toyota Hilux.
- Durable steel construction for maximum strength.
- Designed for fitment of the Redarc's range of BCDC range of chargers.
- Designed for fitment with ARB Dual Battery Wiring Kit part # 4300010.
- Designed to accept a N70ZZL Century Battery (or equivalent). Battery weight not to exceed 25kg. Not suitable for N70ZZ (right hand configuration) batteries.
- Tray is coated with a zinc rich primer and finished in satin black powder coat.
- Provision on tray for fitment of MIDI fuse or 4,6 or 8 block fuse block.

Dual Battery Wiring Kit & BCDC Selection:

ARB's dual battery tray for the MY16 Toyota Hilux has been developed for use with ARB Dual Battery Wiring Kit part number 4300010. The wiring kit includes cables with terminated ring ends for fitment to battery terminals and earth points. It is recommended to use the included soldered butt splice crimp connection with heat shrink when connecting the Redarc BCDC.

ARB's testing of the 4300010 kit included exposure to 80 degrees ambient temperature while running a high current load through the fuse and holder for a continuous duration of 8 hours. ARB's dual battery wiring kit has been designed for those customers using a BCDC with a rated output up to 25 amps at 12 volts.

For vehicles using Redarc's range of 40 amp BCDC chargers or where the vehicle will experience high extremes of temperature or charge duration, Redarc 40 or 60 amp MIDI fuse kits are recommended. These kits use a MIDI fuse in place of the blade fuse included in the 4300010 kit. MIDI fuses overcome the potential for contact resistance through the use of bolts to retain the fuse to the cable.

The table below shows the most appropriate fusing option in conjunction with the 4300010 kit.

BCDC Charger	Description	Economical Option (Normal Use)	Premium Option (Heavy Use)
BCDC1220	S/START DC/DC B/CHGR 12V 20A	4300010	4300010 & REDFK40
BCDC1220-IGN	S/START DC/DC B/CHGR 12V 20A	4300010	4300010 & REDFK40
BCDC1220-LTH	DC/BC B/CHGR 12V 20A OE	4300010	4300010 & REDFK40
BCDC1225	S/START DC/DC B/CHGR 12V 25A	4300010	4300010 & REDFK40
BCDC1225-LV	S/START L/VOLTAGE 12V 25A	4300010	4300010 & REDFK40
BCDC1240	S/START 40AMP 12V DC-DC CHGR	4300010 & REDFK60	4300010 & REDFK60
BCDC1240-LV	S/START L/VOLTAGE 12V 40A	4300010 & REDFK60	4300010 & REDFK60

Blade & MIDI Fuse Holder:

The battery tray has provision for a 4, 6 or 8 blade fuse holder or the Redarc MIDI fuse holder above the BCDC mounting position.

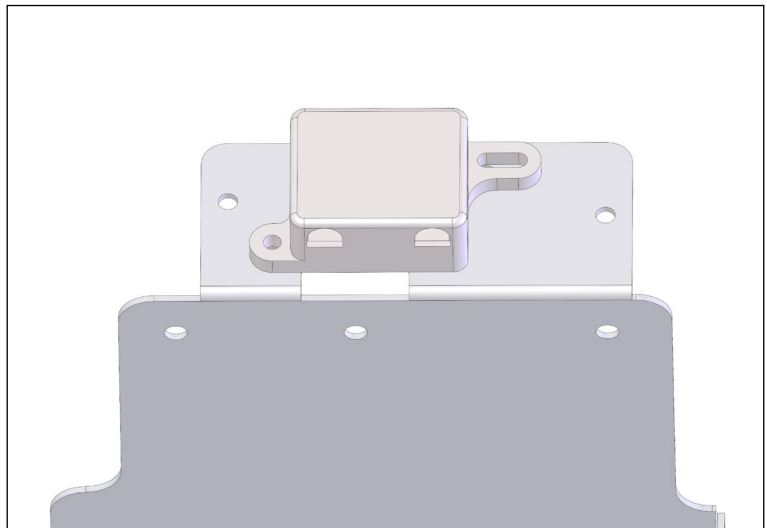
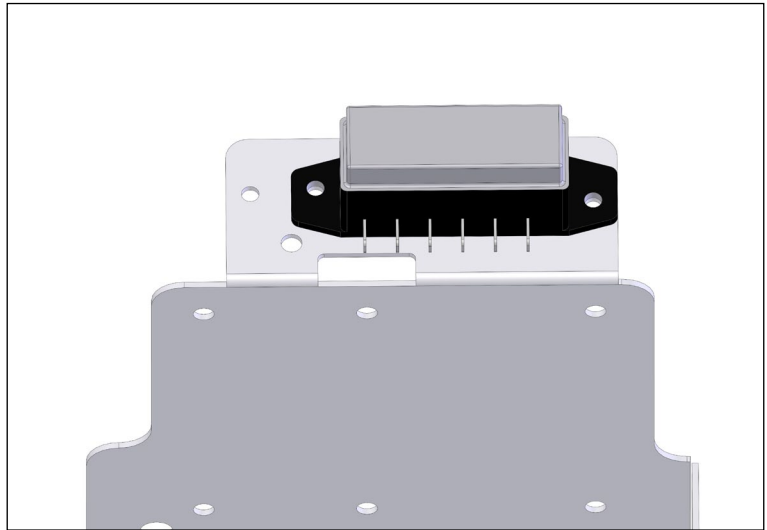

HEAD OFFICE

ARB Corporation Ltd

POSTAL ADDRESS

PO Box 105, Kilsyth
3137 Australia

STREET ADDRESS

42-44 Garden Street,
Kilsyth, Victoria
3136 Australia

CONTACT DETAILS

T +61 3 9761 6622
F +61 3 9761 6807
W arb.com.au